

Water Heaters



- Fused Ceramic Shield™ tank lining is corrosion-resistant for years of dependability.
- Adjustable temperature controls for "set and forget" comfort and convenience.
- Non-CFC foam insulation traps heat inside the tank, saving energy
- Anode rod gives added protection against corrosion
- Heavy-duty burner assembly for even flame distribution, powerful heating and quick recovery. Propane models feature rugged cast-iron burner.
- Unique flue baffle extracts heat for maximum efficiency.



One Year Warranty

Electric								
Stock #	U.S. Gal.	# of Elements	Volts	Weight	Conn.	Height Inches	Dia.	Watts
0431705	30	2	240	79	Side	45-1/4"	18"	4500
0431707	30	2	240	91	Top	29-1/2"	22"	4500
0431739	30	2	240	91	Side	29-1/2"	22"	4500
0431709	30	1	120	91	Top	29-1/2"	22"	1500
0431738	30	1	240	91	Side	29-1/2"	22"	4500
0431716	40	2	240	122	Top	31-5/8"	22"	4500
0431712	40	2	240	94	Top	47-1/4"	20"	4500
0431714	40	2	240	94	Side	47-1/4"	20"	4500
0431711	40	2	240	94	Side	47-1/4"	20"	3500
0431718	50	2	240	115	Top	50"	20"	4500
Five Year Warranty								
PROPANE GAS SEALED COMBUSTION DIRECT VENT*								BTU
0431724	30	n/a	n/a	119	Side/Top	59-3/4"	18"	30,000
0431726	40	n/a	n/a	136	Side/Top	60-3/4"	20"	32,000

Six Year Warranty

ELECTRIC								
Stock #	U.S. Gal.	# of Elements	Volts	Weight	Conn.	Height Inches	Dia.	Watts
0431703	20	1	120	60	Side	25"	18"	1500
0431706	30	2	240	79	Side	45-1/4"	18"	4500
0431708	30	2	240	91	Top	29-1/2"	22"	4500
0431740	30	2	240	91	Side	29-1/2"	22"	4500
0431710	30	1	120	91	Top	29-1/2"	22"	1500
0431741	30	1	120	91	Side	29-1/2"	22"	1500
0431742	30	1	240	91	Side	29-1/2"	22"	3500
0431743	40	1	240	94	Side	47-1/4"	24"	3500
0431717	40	2	240	122	Top	31-3/4"	22"	4500
0431715	40	2	240	94	Side	47-1/4"	20"	4500
0431735	40	2	240	94	Top	47-1/4"	20"	4500
0431719	50	2	240	115	Top	50"	20"	4500
PROPANE*								BTU
0431721	30	3" VENT		98	Top/Top	59-3/4"	16"	30,000
0431723	40	3" VENT		127	Top/Top	62"	18 1/2"	40,000

Nine Year Warranty

ELECTRIC								
Stock #	U.S. Gal.	# of Elements	Volts	Weight	Conn.	Height Inches	Dia.	Watts
0431727	40	2	240	99	Top	47-1/4"	20"	4500
0431746	50	2	240	121	Top	48"	22"	4500

* Comes equipped for LP; contains kit to convert to natural gas.

Vent Packages

for Propane Gas Sealed
Combustion Water Heaters

- 0431748** 12"
- 0431749** 17" - 32"
- 0431750** 32" - 60"
- 0237958** Ceiling Ring



Screw-In Immersion

1" NPT no-taper screw plug. Fits many models of Rheem, State, Ruud, Norge and others. Includes one gasket.

- 0431600** 1750W-120V; 25/Ctn.
- 0431601** 1500W-120V; 25/Ctn.
- 0431602** 4500W-240V; 50/Ctn.
- 0431603** 3500W-240V; 50/Ctn.
- 0431604** 2000W-120V; 25/Ctn.
- 0431607** 3000W-240V; 12/Ctn.



Square Flange

2-1/2" square, flat surface, 2-1/2" bolt circle, 1-49/64" bolt centers. Includes one gasket. 50/Ctn.

- 0430702** 1500W-120V; 50/Ctn.
- 0430703** 4500W-240V; 25/Ctn.



Universal Flange

2-1/2" square flange with raised corners. 2-1/2" bolt circle, 1-49/64" bolt centers. Includes one regular "O" ring. 25/Ctn.

- 0431201** 1500W-120V
- 0431204** 3500W-240V
- 0431203** 4500W-240V



Open Coil Elements

Seven porcelain discs. Stainless steel rod withstands 1300° constant temperature, and the machine-twisted terminal loops insure against burnouts. 50/Ctn.

- 0430503** 1500W-120V
- 0430504** 2000W-240V
- 0430502** 1750W-120V



Gas Valve

Convertible gas valve for mobile home heaters. 1-1/2" shank.

- 0430415** Sealed Combustion
- 0430416** Atmospheric

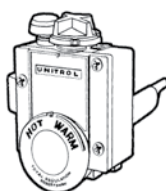

Telescoping Gas Stack and Flue Pipe

Overall length:
22-7/8" with flue pipe
NOT extended.

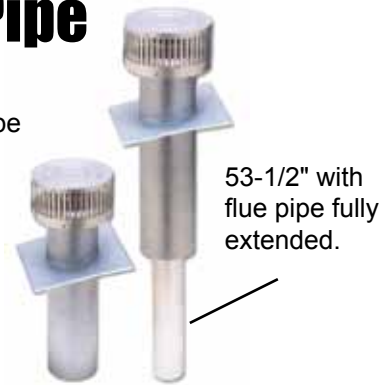

53-1/2" with
flue pipe fully
extended.

For use with propane gas water heaters. Pulls air from inside of home and vents exhaust out of top of home. Flange has 12° angle for sloped roofs. Extends 8-3/4" above roof line.

- 0425195** 4/Ctn.

Universal Adapter Kit

Converts screw-in element to replace round head, flat flange and universal flange. 12/Ctn.

- 0430604**

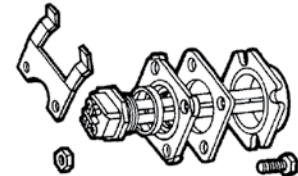

T & P Valve

Temperature and pressure relief valve with test lever, stainless steel spring and all bronze body. Thermostat is positive, accurate and proven. Self-closing. 50/Ctn.

- 0430120** 3/4" x 4" L
- 0432048** 3/4" x 5" L
- 0432046** 1/2" x 4" L



Water Heater Door

Without Vents

- 0212000** 22" x 60"
- 0211997** 23" x 60"

With Vents
(Not Shown)

- 0432050** 22" x 60"
- 0211999** 23" x 60"

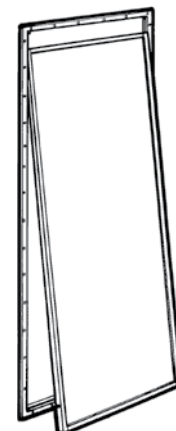

Flexible Water Connectors

Flexible copper connector for water only.

- 0440015** 24"; 25/Ctn.
- 0440010** 18"; 25/Ctn.
- 0440018** Washer



Flexible Gas Connectors

1/2" OD coated brass tubing 1/2" FPT x 1/2" MPT (tapped 3/8" FPT). Approved for indoor and outdoor use. AGA listed.

- 0250815** 18"
- 0250816** 24"
- 0250817** 36"

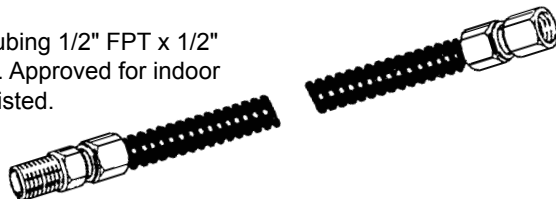

PEX Water Heater Swivel Connectors

3/4" insert x 3/4" FPT for PEX tubing & pipe.

0440017

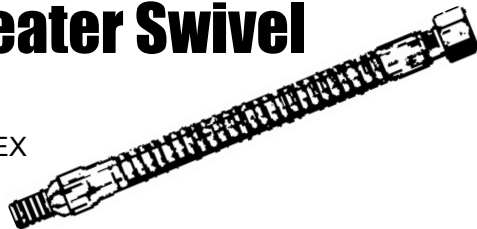

Shark Bite Push-On Water Heater Connector

0440012 3/4" FIP x 3/4" shark bite x 24" long

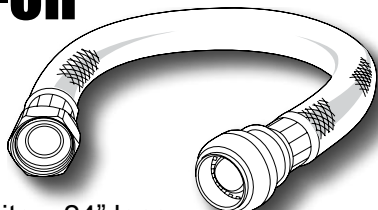

Waterway Connector

For water heater inlet and outlet hookup plus other uses, where dissimilar metals occur in piping and plumbing systems. 3/4" MPT x 3/4" MPT x 3" length MIP. Thermoplastic lining prevents corrosion. Bulk.

0431625



Drip Pan

Plastic polymer, semi-flexible. Pre-drilled to accept furnished 1" PVC plastic fitting. Meets requirement of Southern Building Code.

- 0260155** 22"; 12/Ctn.
- 0260156** 24"; 12/Ctn.



Drain Tool



0380150

Water Heater Insulation

Vinyl-backed Fiberglass Insulation is designed for gas, oil, and electric water heaters up to 60-gallon capacity. Available in a choice of thicknesses to offer you greater R-values.



- 0270500** 2" thick x 48" x 75" R6.7
- 0270501** 3" thick x 48" x 75" R10

Water Heater Thermocouple

Fully universal. Fits push-in, screw-in or clamp-on type pilot burners. 24/Ctn.

- 0232501** 18"
- 0232502** 24"
- 0232503** 30"



Continuity Tester

Tests elements and thermostats while they are in the water heater. LED light indicates continuity. Unbreakable body with protective covers over light and probe.

0382006 12/Ctn.



T-stat

Replacement for any electric, domestic water heater.

- 0431901** Double-throw 240V
- 0431904** Thermo Disc 1-Pole
- 0431906** Lower Thermostat.

